



# Table of Contents

## Categorized Listing

<b>Retainers &amp; Anchors</b>	<b>1</b>		
<b>ANCHORS</b>	<b>11</b>	<b>RETAINING RINGS</b>	<b>6</b>
Toggle Heads	11	External Retaining Rings	6
Zip-It Wall Anchors	11	External Retaining Rings - No Groove	6
Zip-It Wall Anchor Demo	11	External "E" Type Retaining Rings	6
Vinyl Wall Anchors	11	Reinforced "E" Type Retaining Rings	6
Vinyl Wall Anchor Kit	11	Internal Retaining Rings	6
Plastic Toggle Wall Anchors	11	<b>ROLLER CHAIN &amp; YOKE ENDS</b>	<b>8</b>
Hollow Wall Anchors	12	Yoke Ends	8
Hollow Drive Wall	12	Roller Chain	8
Wall-Dog Universal Anchors	12	Offset Link	8
Lok-Bolt	12	Connecting Link	8
Expansion Nut Anchors	12	<b>SHAFT COLLARS</b>	<b>7</b>
Hammer Drive Anchors	13	Set Screw Collars	7
Lag Shield Anchors	13	Two-Piece Clamp	7
Wedge Anchors	14	<b>WOODRUFF KEYS</b>	<b>9</b>
Slotted Flat Head Sleeve Anchors	14	Woodruff Keys	9
Drop-In Anchors	15		
Steel Drop in Anchor Tool	15		
Double Expansion Shields	15		
Wedge-Bolts & Bits	16		
<b>BUSHINGS</b>	<b>5</b>		
Machinery Bushings	5		
Narrow Rim	5		
Wide Rim	5		
<b>KEY STOCK</b>	<b>10</b>		
Plated Key Stock	10		
Zinc Plated Key Stock	10		
Un-Plated Key Stock	10		
Metric Un-Plated Key Stock	10		
<b>PINS</b>	<b>1</b>		
Cotter pins	1		
Tractor Pins	1		
Lynch Pins	1		
Hitch Pins	1		
Hairpin Cotters	2		
Double Bow Hairpin	2		
Dowel Pins	2		
Clevis Pins	3		
Standard	3		
Universal	3		
Spring Roll Pins	4		
Spiral Pins	4		

## Table of Contents

### Alphabetized Listing

<b>A</b>	
ANCHORS	11-14
<b>B</b>	
BUSHINGS	5
<b>C</b>	
Clevis Pins	3
Connecting Link	8
Cotter pins	1
<b>D</b>	
Double Bow Hairpin	2
Double Expansion Shields	14
Dowel Pins	2
Drop-In Anchors	14
<b>E</b>	
Expansion Nut Anchors	12
External "E" Type Retaining Rings	6
External Retaining Rings	6
External Retaining Rings - No Groove	6
<b>H</b>	
Hairpin Cotters	2
Hammer Drive Anchors	13
Hitch Pins	1
Hollow Drive Wall	12
Hollow Wall Anchors	12
<b>I</b>	
Internal Retaining Rings	6
<b>K</b>	
KEY STOCK	10
<b>L</b>	
Lag Shield Anchors	13
Lok-Bolt	12
Lynch Pins	1
<b>M</b>	
Machinery Bushings	5
Metric Un-Plated Key Stock	10
<b>N</b>	
Narrow Rim	5
<b>O</b>	
Offset Link	8
<b>P</b>	
PINS	1-4
Plastic Toggle Wall Anchors	11
Plated Key Stock	10
<b>R</b>	
Reinforced "E" Type Retaining Rings	6
Retainers & Anchors	1-14
RETAINING RINGS	6
Roller Chain	8
ROLLER CHAIN & YOKE ENDS	8
<b>S</b>	
Set Screw Collars	7
SHAFT COLLARS	7
Slotted Flat Head Sleeve Anchors	14
Spiral Pins	4
Spring Roll Pins	4
Standard	3
Steel Drop in Anchor Tool	14
<b>T</b>	

Toggle Heads	11
Tractor Pins	1
Two-Piece Clamp	7
<b>U</b>	
Universal	3
Un-Plated Key Stock	10
<b>V</b>	
Vinyl Wall Anchor Kit	11
Vinyl Wall Anchors	11
<b>W</b>	
Wall-Dog Universal Anchors	12
Wedge Anchors	13-14
Wide Rim	5
Woodruff Keys	9
WOODRUFF KEYS	9
<b>Y</b>	
Yoke Ends	8
<b>Z</b>	
Zinc Plated Key Stock	10
Zip-It Wall Anchor Demo	11
Zip-It Wall Anchors	11

NEBRASKA-IOWA  
INDUSTRIAL  
FASTENERS CORP.



# PINS

## Cotter pins



- Extended Zinc prong
- Zinc plated

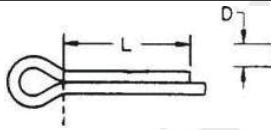

- Length of pin is measured from under the head to the end of the shorter prong

Item ID	Diameter	Length
96000	1/16	3/4
96001	1/16	1
96002	1/16	1 1/4
96003	1/16	1 1/2
96004	1/16	1 3/4
96005	1/16	2
96016	3/32	3/4
96017	3/32	1
96018	3/32	1 1/4
96019	3/32	1 1/2
96020	3/32	1 3/4
96021	3/32	2
96023	3/32	2 1/2
96025	3/32	3
96032	7/64	1
96035	7/64	1 1/2
96037	7/64	2
96047	1/8	3/4
96048	1/8	1
96049	1/8	1 1/4
96050	1/8	1 1/2
96051	1/8	1 3/4
96052	1/8	2
96054	1/8	2 1/2
96056	1/8	3
96063	5/32	3/4
96064	5/32	1
96065	5/32	1 1/4
96066	5/32	1 1/2
96067	5/32	1 3/4
96068	5/32	2
96070	5/32	2 1/2
96072	5/32	3
96080	3/16	1

Item ID	Diameter	Length
96081	3/16	1 1/4
96082	3/16	1 1/2
96083	3/16	1 3/4
96084	3/16	2
96086	3/16	2 1/2
96088	3/16	3
96090	3/16	4
96091	7/32	1 1/2
96092	7/32	2
96093	7/32	2 1/2
96094	7/32	3
96096	1/4	1
96097	1/4	1 1/4
96098	1/4	1 1/2
96100	1/4	2
96102	1/4	2 1/2
96104	1/4	3
96106	1/4	4
96107	1/4	4-1/2
96114	5/16	1 1/2
96116	5/16	2
96118	5/16	2 1/2
96120	5/16	3
96122	5/16	4
96132	3/8	2
96134	3/8	2 1/2
96136	3/8	3
96137	3/8	3 1/2
96138	3/8	4
96139	3/8	5
96142	3/8	6
96152	1/2	3
96154	1/2	4
96158	1/2	6

## Tractor Pins



Item ID	Diameter	Usable Length	Handle Shape
17002	1/4	1-3/4	Round
17003	1/4	2-1/2	Square
17004	5/16	2-1/2	Square
17006	3/8	2-1/4	Round
17008	3/8	2-1/4	Square

## Lynch Pins



Item ID	Pin Diameter	Usable Length
17010	3/16	1-1/4
17011	1/4	1-5/16
17012	5/16	1-3/8
17013	7/16	1-3/8
17014	7/16	1-5/8
17015	3/8	1-1/4

## Hitch Pins



Item ID	Shank Diameter	Usable Length
17150	5/8	4-1/4
17155	3/4	4-1/4
17157	3/4	6-1/4
17165	7/8	7
17175	1	6-1/4

# PINS

## Hairpin Cotter

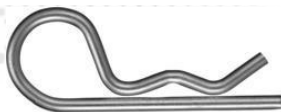

Item ID	Overall Length	Wire Diameter	Fits Shaft Size
16499	1-1/8	.070	1/4 to 3/8
16500	1-1/8	.059	1/4 to 5/16
16502	1-7/16	.073	5/16 to 3/8
16508	1-9/16	.062	3/8 to 1/2
16510	1-15/16	.125	1/2 to 3/4
16512	1-7/8	.092	3/8 to 7/16
16516	2-5/16	.093	1/4 to 5/8
16518	2-3/8	.120	1/2 to 5/8
16520	2-1/2	.125	5/8 to 7/8
16522	2-9/16	.148	5/8 to 3/4
16524	3-3/4	.178	7/8 to 1
16528	4-1/16	.310	7/8 to 1
16540	5	.243	1-1/8 to 1-1/2
17050	3/8	.035	-
17054	19/32	.045	-
17056	7/8	.050	-
17057	3/4	.050	-
17059	1-3/16	.070	-

## Dowel Pins



Item ID	Diameter	Length
96885	1/8	1
96890	3/16	1/2
96892	3/16	3/4
96894	3/16	1
96896	3/16	1-1/4
96898	3/16	1-1/2
96902	3/16	2
96904	1/4	3/4
96906	1/4	1
96908	1/4	1-1/4
96910	1/4	1-1/2
96912	1/4	1-3/4
96914	1/4	2
96920	5/16	3/4
96922	5/16	1
96924	5/16	1-1/4
96926	5/16	1-1/2
96928	5/16	1-3/4
96930	5/16	2
96938	3/8	1
96940	3/8	1-1/4
96942	3/8	1-1/2
96944	3/8	1-3/4
96946	3/8	2
96948	3/8	2-1/2
96950	3/8	3
96952	1/2	1
96953	1/2	1-1/4
96954	1/2	1-1/2
96956	1/2	2
96958	1/2	2-1/2
96959	1/2	3
96960	1/2	4
96962	5/8	1-1/2
96964	5/8	2
96966	5/8	2-1/2
96968	5/8	3
96974	3/4	3
96976	3/4	4
96978	3/4	5

## Double Bow Hairpin

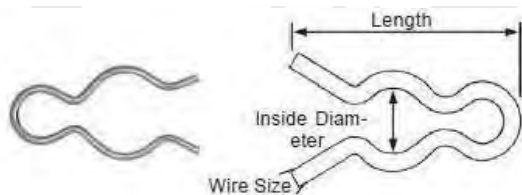

Item ID	Inside Diameter	Overall Length	Wire Diameter
54600	1/32	3/8	
54604	1/16	23/64	0.025
54608	5/64	13/32	0.025
54612	3/32	3/8	0.025
54616	3/32	13/32	0.025
54620	3/32	1/2	0.025
54632	1/8	31/64	.045
54640	9/64	15/32	
54644	5/32	31/64	.025
54648	5/32	5/8	.045
54656	7/32	3/4	.060
54660	9/32	13/16	
54664	5/16	1	.060
54668	3/8	7/8	.075

# PINS

## Clevis Pins

### Standard

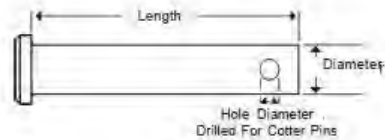

Item ID	Diameter	Length	Hole Diameter for Cotter Pin
16603	3/16	3/4	3/32
16604	3/16	7/8	3/32
16605	3/16	1	3/32
16606	3/16	1-1/4	3/32
16612	1/4	3/4	3/32
16615	1/4	1	3/32
16617	1/4	1-1/4	3/32
16619	1/4	1-1/2	3/32
16620	1/4	1-3/4	3/32
16622	1/4	2	3/32
16624	1/4	2-1/4	3/32
16626	1/4	2-1/2	3/32
16628	1/4	2-3/4	3/32
16630	1/4	3	3/32
16640	5/16	3/4	1/8
16641	5/16	7/8	1/8
16642	5/16	1	1/8
16645	5/16	1-1/4	1/8
16647	5/16	1-1/2	1/8
16654	5/16	2	1/8
16656	5/16	2-1/4	1/8
16658	5/16	2-1/2	1/8
16660	5/16	2-3/4	1/8
16662	5/16	3	1/8
16672	3/8	3/4	5/32
16673	3/8	1	5/32
16676	3/8	1-1/4	5/32
16679	3/8	1-1/2	5/32
16681	3/8	1-3/4	5/32
16683	3/8	2	5/32
16685	3/8	2-1/4	5/32
16687	3/8	2-1/2	5/32
16689	3/8	2-3/4	5/32
16691	3/8	3	5/32

Item ID	Diameter	Length	Hole Diameter for Cotter Pin
16698	7/16	1	5/32
16700	7/16	1-1/4	5/32
16701	7/16	1-1/2	5/32
16704	7/16	2	5/32
16705	7/16	2-1/4	5/32
16707	7/16	2-1/2	5/32
16713	1/2	1	5/32
16714	1/2	1-1/4	5/32
16717	1/2	1-1/2	5/32
16718	1/2	1-3/4	5/32
16719	1/2	2	5/32
16720	1/2	2-1/4	5/32
16721	1/2	2-1/2	5/32
16722	1/2	2-3/4	5/32
16724	1/2	3	5/32
16726	1/2	4	5/32
16740	5/8	1-1/2	5/32
16742	5/8	2	5/32
16744	5/8	2-1/2	5/32
16747	5/8	3	5/32

### Universal

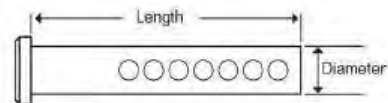

Item ID	Diameter	Length
16805	1/4	2
16810	5/16	2
16817	3/8	2
16822	7/16	2
16823	7/16	2-1/2
16824	7/16	3
16827	1/2	2
16828	1/2	2-1/2
16829	1/2	3
16833	5/8	3

# PINS

## Spring Roll Pins



• Zinc Plated

Item ID	Diameter	Length
96500	1/16	3/16
96501	1/16	1/4
96503	1/16	3/8
96505	1/16	1/2
96507	1/16	5/8
96509	1/16	3/4
96510	1/16	13/16
96511	1/16	7/8
96513	1/16	1
96516	5/64	1/4
96518	5/64	3/8
96520	5/64	1/2
96521	5/64	9/16
96522	5/64	5/8
96525	5/64	3/4
96529	5/64	1
96531	5/64	1-1/4
96533	5/64	1-1/2
96535	3/32	1/4
96536	3/32	5/16
96537	3/32	3/8
96538	3/32	7/16
96539	3/32	1/2
96541	3/32	5/8
96543	3/32	3/4
96544	3/32	13/16
96545	3/32	7/8
96547	3/32	1
96548	3/32	1-1/8
96549	3/32	1-1/4
96550	3/32	1-3/8
96551	3/32	1-1/2
96557	1/8	3/8
96559	1/8	1/2
96561	1/8	5/8
96563	1/8	3/4
96565	1/8	7/8
96567	1/8	1
96568	1/8	1-1/8
96569	1/8	1-1/4
96571	1/8	1-1/2
96573	1/8	1-3/4
96575	1/8	2
96581	5/32	1/2
96585	5/32	3/4
96589	5/32	1
96591	5/32	1-1/4

Item ID	Diameter	Length
96593	5/32	1-1/2
96595	5/32	1-3/4
96597	5/32	2
96601	5/32	2-1/2
96612	3/16	1/2
96614	3/16	5/8
96616	3/16	3/4
96620	3/16	1
96621	3/16	1-1/8
96622	3/16	1-1/4
96623	3/16	1-3/8
96624	3/16	1-1/2
96625	3/16	1-5/8
96626	3/16	1-3/4
96627	3/16	1-7/8
96628	3/16	2
96632	3/16	2-1/2
96640	7/32	9/16
96643	7/32	3/4
96645	7/32	7/8
96646	7/32	15/16
96647	7/32	1
96648	7/32	1-1/8
96649	7/32	1-1/4
96650	7/32	1-3/8
96651	7/32	1-1/2
96652	7/32	1-5/8
96653	7/32	1-3/4
96655	7/32	2
96659	7/32	2-1/2
96663	7/32	3
96670	1/4	1/2
96672	1/4	5/8
96674	1/4	3/4
96675	1/4	13/16
96676	1/4	7/8
96677	1/4	15/16
96678	1/4	1
96679	1/4	1-1/8
96680	1/4	1-1/4
96681	1/4	1-3/8
96682	1/4	1-1/2
96683	1/4	1-5/8
96684	1/4	1-3/4
96685	1/4	1-7/8
96686	1/4	2
96688	1/4	2-1/4
96690	1/4	2-1/2
96692	1/4	2-3/4
96694	1/4	3
96698	1/4	3-1/2
96705	5/16	3/4
96707	5/16	7/8

Item ID	Diameter	Length
96709	5/16	1
96711	5/16	1-1/4
96712	5/16	1-3/8
96713	5/16	1-1/2
96715	5/16	1-3/4
96716	5/16	1-7/8
96717	5/16	2
96719	5/16	2-1/4
96721	5/16	2-1/2
96723	5/16	2-3/4
96725	5/16	3
96727	5/16	3-1/4
96729	5/16	3-1/2
96731	5/16	3-3/4
96733	5/16	4
96740	3/8	3/4
96743	3/8	1
96745	3/8	1-1/4
96747	3/8	1-1/2
96749	3/8	1-3/4
96751	3/8	2
96753	3/8	2-1/4
96755	3/8	2-1/2
96757	3/8	2-3/4
96759	3/8	3
96761	3/8	3-1/4
96763	3/8	3-1/2
96766	3/8	4
96775	7/16	1
96777	7/16	1-1/4
96779	7/16	1-1/2
96781	7/16	1-3/4
96783	7/16	2
96787	7/16	2-1/2
96791	7/16	3
96799	7/16	4
96810	1/2	1-1/4
96812	1/2	1-1/2
96814	1/2	1-3/4
96816	1/2	2
96818	1/2	2-1/4
96820	1/2	2-1/2
96822	1/2	2-3/4
96824	1/2	3
96826	1/2	3-1/4
96828	1/2	3-1/2
96830	1/2	3-3/4
96832	1/2	4

## Spiral Pins



Item ID	Diameter	Length
96401	1/8	1/2
96403	1/8	3/4
96405	1/8	1
96407	1/8	1-1/4
96408	1/8	1-1/2
96410	1/8	2
96427	3/16	1/2
96437	3/16	2
96448	1/4	3/4
96450	1/4	1
96452	1/4	1-1/4
96454	1/4	1-1/2
96458	1/4	2
96460	1/4	2-1/2
96469	5/16	1
96470	5/16	1-1/4
96471	5/16	1-1/2
96474	5/16	2
96477	5/16	2-1/2
96486	3/8	1
96487	3/8	1-1/4
96488	3/8	1-1/2
96492	3/8	2
96495	3/8	2-1/2



# BUSHINGS

## Machinery Bushings

### Narrow Rim

Precision Finished – For Shimming or Bushing Gears, Sprockets, Bearings, Etc.

14 Gauge (Medium)

Item ID	Inside Diameter	Outside Diameter
17625	1/2	7/8
17626	9/16	1
17627	5/8	1
17628	3/4	1-1/4
17629	7/8	1-3/8
17630	1	1-1/2
17631	1-1/8	1-3/4
17632	1-1/4	1-7/8
17633	1-3/8	2-1/8
17634	1-1/2	2-1/4
17635	1-5/8	2-3/8
17636	1-3/4	2-1/2
17637	1-7/8	2-7/8
17638	2	3
17639	2-1/8	3-1/8
17640	2-1/4	3-1/4
17642	2-1/2	3-1/2

### Wide Rim



Item ID	Inside Diameter	Outside Diameter
17650	5/8	1-1/4
17651	3/4	1-1/2
17652	7/8	1-3/4
17653	1	2
17654	1-1/8	2-1/8
17655	1-1/4	2-1/4
17656	1-3/8	2-1/2
17657	1-1/2	3
17658	1-5/8	3-1/8
17659	1-3/4	3-1/4
17660	1-7/8	3-3/8
17661	2	3-1/2
17662	2-1/8	3-5/8
17663	2-1/4	3-3/4
17664	2-1/2	3-7/8
17665	2-3/4	4
17666	3	4-1/4



# RETAINING RINGS

## External Retaining Rings

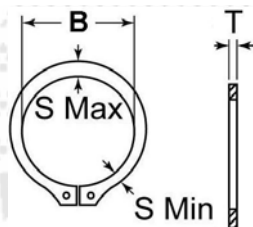

Item ID	Shaft Dia.	Free Dia. (B)	Thk (T)
54000	1/8	0.112	0.010
54004	1/4	0.225	0.025
54008	9/32	0.256	0.025
54012	5/16	0.281	0.025
54016	11/32	0.309	0.025
54020	3/8	0.338	0.025
54024	13/32	0.366	0.025
54028	7/16	0.395	0.025
54032	1/2	0.461	0.035
54036	9/16	0.521	0.035
54040	19/32	0.550	0.035
54044	5/8	0.579	0.035
54048	11/16	0.635	0.042
54052	3/4	0.693	0.042
54056	13/16	0.751	0.042
54060	7/8	0.810	0.042
54064	15/16	0.867	0.042
54068	1	0.925	0.042
54072	1-1/16	0.982	0.050
54076	1-1/8	1.041	0.050
54080	1-3/16	1.098	0.050
54084	1-1/4	1.156	0.050
54086	1-3/8	1.272	0.050
54088	1-1/2	1.387	0.050
54090	1-9/16	1.446	0.062
54091	1-5/8	1.503	0.062
54092	1-3/4	1.618	0.062
54096	2	1.850	0.062
54100	2-1/4	2.081	0.078
54104	2-1/2	2.313	0.078

## External Retaining Rings - No Groove

Item ID	Shaft Dia.	Fits Shaft
54200	3/32	.092 to .096
54204	1/8	.123 to .127
54208	3/16	.185 to .189
54212	1/4	.248 to .252
54216	5/16	.310 to .316
54220	3/8	.373 to .379
54224	7/16	.434 to .440
54228	1/2	.467 to .503
54232	5/8	.622 to .628

## External "E" Type Retaining Rings

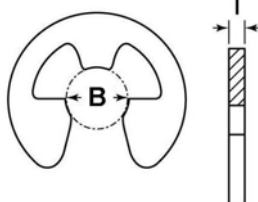

Item ID	Shaft Dia.	Free Dia. (B)	Thk (T)
54500	1/16	0.052	0.012
54504	3/32	0.074	0.018
54508	1/8	0.095	0.018
54512	9/64	0.105	0.018
54516	5/32	0.116	0.029
54520	11/64	0.127	0.029
54524	3/16	0.125	0.029
54528	7/32	0.188	0.029
54532	1/4	0.21	0.029
54536	5/16	0.26	0.029
54540	3/8	0.303	0.039
54544	7/16	0.343	0.039
54548	1/2	0.369	0.046
54552	5/8	0.485	0.046
54556	3/4	0.625	0.056
54560	7/8	0.675	0.056
54564	1	0.835	0.056
54568	1 3/16	1.079	0.068
54570	1 3/8	1.23	0.068

## Reinforced "E" Type Retaining Rings

Item ID	Shaft Dia. "A"	Free Dia. "B"	Thickness
54400	3/32	0.018	0.074
54404	1/8	0.018	0.095
54408	5/32	0.029	0.116
54412	3/16	0.029	0.147
54416	7/32	0.029	0.188
54420	1/4	0.029	0.21
54424	5/16	0.039	0.25
54428	3/8	0.039	0.303
54432	7/16	0.039	0.343
54436	1/2	0.046	0.396
54440	9/16	0.046	0.437

## Internal Retaining Rings

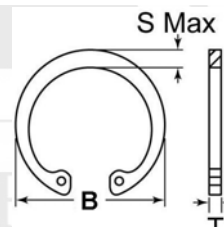

Item ID	Shaft Dia.	Free Dia. (B)	Thk (T)
54300	1/4	0.280	0.015
54304	5/16	0.346	0.015
54308	3/8	0.415	0.025
54312	7/16	0.482	0.025
54316	1/2	0.548	0.035
54320	9/16	0.620	0.035
54324	5/8	0.694	0.035
54328	3/4	0.831	0.035
54330	13/16	0.901	0.042
54332	7/8	0.971	0.042
54334	15/16	1.041	0.042
54336	1	1.111	0.042
54340	1-1/8	1.249	0.050
54344	1-1/4	1.388	0.050
54348	1-5/16	1.456	0.050
54352	1-3/8	1.526	0.050
54356	1-7/16	1.596	0.050
54360	1-1/2	1.660	0.050
54364	1-5/8	1.804	0.062
54368	1-3/4	1.942	0.062
54371	1-7/8	2.054	0.062
54373	2	2.210	0.062

## Snap Ring Pliers- Straight Tip



Item ID	Size	For Use With
54700	Small	Ext: 1/4"-5/8" Int: 3/8"-7/16"
54701	Medium	Ext: 11/16"-7/8" Int: 29/64-1.023"

# SHAFT COLLARS

## Set Screw Collars



- Precision-machined collars of solid cold-drawn steel
- Zinc plated to control rust
- Each collar supplied with socket head set screw

Item ID	Inside Diameter
17698	1/4
17699	5/16
17700	3/8
17701	7/16
17702	1/2
17704	5/8
17706	3/4
17708	7/8
17710	15/16
17712	1
17714	1-1/16
17716	1-1/8
17718	1-3/16
17720	1-1/4
17722	1-5/16
17724	1-3/8
17726	1-7/16
17728	1-1/2
17730	1-5/8
17732	1-3/4
17734	1-7/8
17736	1-15/16
17738	2
17740	2-1/4
17742	2-1/2
17744	2-3/4
17746	2-15/16
17748	3

## Two-Piece Clamp



- Does not mar the shaft
- Single point faced
- Opposing screws available
- Screws included with collars
- Width tolerance = .003" - .010"

Item ID	Size
16902	1/4
16903	5/16
16904	3/8
16905	7/16
16906	1/2
16908	5/8
16910	3/4
16912	7/8
16914	1
16915	1-1/16
16916	1-1/8
16917	1-3/16
16918	1-1/4
16920	1-3/8
16922	1-1/2
16924	1-5/8
16926	1-3/4
16928	1-7/8
16930	2

# ROLLER CHAIN & YOKE ENDS

## Yoke Ends

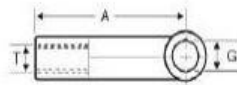

Item ID	Tap Size "T"	Length "A"	Diameter "G"
17450	1/4-28	2	1/4
17452	5/16-24	2-1/4	5/16
17454	3/8-24	2-1/2	3/8
17456	7/16-20	2-7/8	7/16
17458	1/2-20	3	1/2
17460	5/8-18	4-15/16	5/8

## Roller Chain



### Elite Roller Chain ISO 9001 Certified

Exceeds all requirements of the ANSIB29.1 specifications.  
These chains offer high quality with proven performance.

Item ID	Ind No	Pitch	Roller Diameter	Roller Width	Pin Diameter	Plate Height	Thickness	Length
18030	35	0.375	0.2	0.188	0.141	0.347	0.05	10 ft.
18040	40	0.5	0.312	0.313	0.156	0.457	0.06	10 ft.
18050	50	0.625	0.4	0.375	0.2	0.571	0.08	10 ft.
18060	60	0.75	0.469	0.5	0.234	0.689	0.094	10 ft.
18080	80	1	0.625	0.625	0.312	0.921	0.125	10 ft.

## Offset Link



Item ID	Description
18036	#35
18046	#40
18056	#50
18059	#50H
18066	#60
18069	#60H
18086	#80
18089	#80H
18106	#100

## Connecting Link



Item ID	Description
18035	#35
18045	#40
18055	#50
18058	#50
18065	#60
18068	#60H
18085	#80
18088	#80H
18105	#100

# WOODRUFF KEYS

## Woodruff Keys



- Cold Finished Steel- Plain Finish
- Designed to be installed deep into shaft and firmly embedded
- \* *Low Profile*

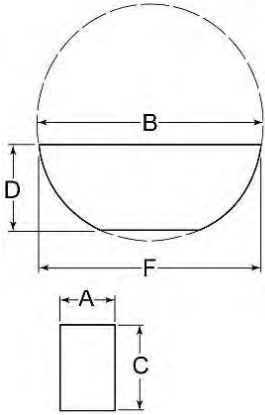

Item ID	Length (B)	Thickness (A)	Industry #
14000	1/2	1/16	1
14001	1/2	3/32	2
14002	1/2	1/8	3
14003	5/8	3/32	4
14004	5/8	1/8	5
14005	5/8	5/32	6
14006	5/8	3/16	61
14007	3/4	1/8	7
14008	3/4	5/32	8
14009	3/4	3/16	9
14010	3/4	1/4	91
14011	7/8	5/32	10
14012	7/8	3/16	11
14013	7/8	7/32	12
14014	7/8	1/4	A
14016	1	3/16	13
14017	1	7/32	14
14015*	1	1/4	141
14018	1	1/4	15
14019	1	5/16	B
14020	1	3/8	152
14021	1-1/8	3/16	16
14022	1-1/8	7/32	17
14023	1-1/8	1/4	18
14024	1-1/8	5/16	C
14025	1-1/4	3/16	19
14026	1-1/4	7/32	20
14027	1-1/4	1/4	21
14028	1-1/4	5/16	D
14029	1-1/4	3/8	E
14030	1-3/8	1/4	22
14031	1-3/8	5/16	23
14032	1-3/8	3/8	F
14033	1-1/2	1/4	24
14034	1-1/2	5/16	25
14035	1-1/2	3/8	G
14036*	2-1/8	3/16	126
14037*	2-1/8	1/4	127
14038*	2-1/8	5/16	128
14039*	2-1/8	3/8	129
14040	2-1/8	3/16	26
14041	2-1/8	1/4	27
14042	2-1/8	5/16	28
14043	2-1/8	3/8	29
14044	2-3/4	1/4	RX
14045	2-3/4	3/8	TX
14046	2-3/4	1/2	VX

# KEY STOCK

## Plated Key Stock



Item ID	Size	Length	Shape
14102	1/8 (.125)	12"	Square
14103	3/16 (.1875)	12"	Square
14104	1/4 (.25)	12"	Square
14105	5/16 (.3125)	12"	Square
14106	3/8 (.375)	12"	Square
14107	7/16 (.4375)	12"	Square
14108	1/2 (.50)	12"	Square
14109	9/16 (.5625)	12"	Square
14110	5/8 (.625)	12"	Square
14111	3/4 (.75)	12"	Square
14112	7/8 (.875)	12"	Square
14113	1	12"	Square

## Plated Rectangle Key Stock

Item ID	Size	Length	Shape
14125	1/8 x 1/4	12"	Rectangular
14128	3/16 x 1/4	12"	Rectangular
14131	1/4 x 5/16	12"	Rectangular
14132	1/4 x 3/8	12"	Rectangular
14135	5/16 x 3/8	12"	Rectangular
14138	3/8 x 1/2	12"	Rectangular
14142	1/2 x 5/8	12"	Rectangular

## Un-Plated Key Stock



Item ID	Size	Length	Shape
14114	1/8 (.125)	12"	Square
14115	3/16 (.1875)	12"	Square
14116	1/4 (.25)	12"	Square
14117	5/16 (.3125)	12"	Square
14118	3/8 (.375)	12"	Square
14119	7/16 (.4375)	12"	Square
14120	1/2 (.50)	12"	Square
14121	5/8 (.625)	12"	Square
14122	3/4 (.75)	12"	Square
14123	7/8 (.875)	12"	Square
14124	1	12"	Square

## Metric Un-Plated Key Stock

Item ID	Size	Length	Shape
14152	4 X 4 MM	12" (305mm)	Square
14154	5 X 5 MM	12" (305mm)	Square
14156	6 X 6 MM	12" (305mm)	Square
14157	7 X 7 MM	12" (305mm)	Square
14161	8 X 8 MM	12" (305mm)	Square
14164	10 X 10 MM	12" (305mm)	Square
14168	12 X 12 MM	12" (305mm)	Square
14171	14 X 14 MM	12" (305mm)	Square
14174	16 X 16 MM	12" (305mm)	Square
14177	18 X 18 MM	12" (305mm)	Square
14180	20 X 20 MM	12" (305mm)	Square

# ANCHORS

## Toggle Heads



### Toggle Heads Only

For machine screws see Screws section:  
Slotted Round Head Plated Machine Screw

Item ID	Screw Diameter	Drill Size
16164	8-32	
16165	6-32	3/8
16166	10-24	1/2
16167	1/4-20	5/8
16168	5/16-18	7/8
16169	3/8-16	7/8
16170	1/2-13	1-3/8

## Zip-It Wall Anchors



- Use sheet metal or dry wall screws
- Features Snap Open Action
- Ideal for all hollow wall applications
- Strong and dependable where there is a need for an inaccessible attachment

Item ID	Type	Screw Size
16172	Steel	#8
16173	Nylon	#8
16174	Nylon	#6

## Zip-It Wall Anchor Demo

NO PRE-DRILLING REQUIRED

1. Place #2 Phillips screwdriver into recess.



2. Press into hollow wall while turning clockwise until it is seated flush with the wall.



3. Place fixture over Zip-It and INSERT SCREW SUPPLIED. Tighten screw, be sure not to over-tighten.

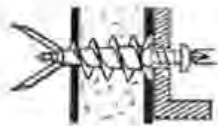

\*Ask your sales representative about our Zip-It assortment or get the details on our custom made assortments of toggle heads and machine screws

## Vinyl Wall Anchors



- A fast, economical fastener for all types of material.
- Use as blind hole fastener in brick or concrete.
- Use as a hollow wall fastener in plaster, drywall, or paneling.
- Pre-drill recommended hole, insert anchor tool in hole and it's ready to accept screw and fixture.

Item ID	Diameter & Length	Screw Size	Drill Hole Size
16049	3/16 x 3/4	6-8	3/16
16050	3/16 x 7/8	8-10	3/16
16051	1/4 x 1	10-12	1/4
16052	5/16 x 1-1/2	14-16	5/16

## Vinyl Wall Anchor Kit



For light duty fastening in concrete, brick, masonry, or drywall.

It's rigid body will not permit the anchor to turn.

Item ID	Plastic Anchors	Slotted Pan Head Screws	Drill Bit
16060	100 - #10 or #12 screw	100 - #10 x 1 screws	1/4 Carbide Drill Bit

## Plastic Toggle Wall Anchors



- Use as a toggle in drywall or wood
- Use as a plug in drywall, masonry, and concrete
- Attach signs, posters, frames, etc.
- Just drill a 5/16" hole and squeeze

Item ID	Grip Range	Hole Size
16070	1/4 - 1/2	5/16
16072	1/2 - 5/8	5/16

# ANCHORS

## Hollow Wall Anchors



- This anchor is designed to be used in shallow materials such as wallboard, drywall, paneling, etc.
- As the screw in the anchor is turned, the anchor secures itself to the back side of the shallow material.
- Grip ranges from 1/16" thick to 1 1/2" thick.
- Allows you to keep hole size to a minimum.
- Complete with machine screw

Item ID	Anchor Size	Anchor Length	Hole Size	Grip Range
16100	1/8	Ex-Short	5/16	1/8 to 1/4
16101	1/8	Short	1/4	3/8 to 1/2
16103	1/8	Long	1/4	5/8 to 1
16105	3/16	Short	3/8	3/8 to 5/8
16106	3/16	Long	3/8	3/4 to 1-1/8
16109	1/4	Short	1/2	3/8 to 1/2
16110	1/4	Long	1/2	5/8 to 1-1/8

## Hollow Drive Wall



Item ID	Anchor Size	Anchor Length	Grip Range
16112	1/8	Long	1/2 to 3/4

## Wall-Dog Universal Anchors



Item ID	Hd Type	Hd Color	Qty
16092	Oval	Chrome	100
16094	Pan	Chrome	100
16096	Oval	White	100
16098	Pan	White	100

## Lok-Bolt



The Lok-Bolt™ is a pre-assembled single unit sleeve anchor available in carbon steel and stainless steel which can be used in concrete, block, brick, and stone.

Extension sleeves are added to create longer lengths.

Item ID	Size	Drill Diameter	Min. Embed.
16180	5/16 X 1-1/2	5/16	1-3/8

## Expansion Nut Anchors



### (Internal Threads for Machine Screws)

- Ideal for anchoring equipment to concrete, brick, stone, etc.
- Lead sleeve and alloy cone resist oxidation.
- Fixtures removable.
- Attractive and finished appearance.
- No studs show when installed - the nut is in the hole. Masonry can be resurfaced.

Item ID	Screw Size	Drill Size	Min. Depth
16025	8 - 32	3/8	1/2
16026	10 - 24	5/16	5/8
16027	1/4 - 20	1/2	7/8
16028	5/16 - 18	5/8	1
16029	3/8 - 16	3/4	1-1/4
16030	1/2 - 13	7/8	1-1/2

# ANCHORS

## Hammer Drive Anchors



The Hammer Drive Anchor is an easy to use expansion anchor. Drill the anchor hole through the material to be fastened, place the anchor into the hole – a blow from a hammer will force the nail to expand for a permanent, reliable fastening.

Item ID	Anchor Size
16065	1/4 X 1
16066	1/4 X 1-1/4
16067	1/4 X 1-1/2

## Lag Shield Anchors



Designed for medium duty fastening on concrete, masonry, and brick. The Lag Shield is used with a lag screw to provide a dependable fastening. In hard masonry, short Lag Shields may be used to minimize drilling time. In softer masonry, the long Lag Shield will develop maximum holding strength.

Item ID	Diameter	Drill Diameter	Min. Depth	Length
88300	1/4	1/2	1	Regular
88301	1/4	1/2	1-1/2	Long
88302	5/16	1/2	1-1/4	Regular
88303	5/16	1/2	1-3/4	Long
88304	3/8	5/8	1-3/4	Regular
88305	3/8	5/8	2-1/2	Long
88306	1/2	3/4	2	Regular
88307	1/2	3/4	3	Long



# ANCHORS

## Wedge Anchors



Use in:

- Concrete or Wood

For heavy duty fastening applications where high pull out values in concrete are needed.

Install:

- Dock Bumpers, Hand Rails, Storage Racks, and Machinery

The anchor and the hole diameter are the same, simplifying installation by placing the anchor through the existing hole in the material to be fastened.

**\*For Stainless Wedge Anchors click here or see Hardware Stainless Section (pg 38)**

Item ID	Type	Diameter	Length	Hole Size	Thread Length
16125	Zinc Plated	1/4	1-3/4	1/4	3/4
16126	Zinc Plated	1/4	2-1/4	1/4	1-1/4
16127	Zinc Plated	1/4	3-1/4	1/4	2-1/4
16129	Zinc Plated	3/8	2-1/4	3/8	1-1/4
16130	Zinc Plated	3/8	2-3/4	3/8	1-5/8
16131	Zinc Plated	3/8	3	3/8	1-7/8
16132	Zinc Plated	3/8	3-3/4	3/8	2-5/8
16133	Zinc Plated	3/8	5	3/8	3-7/8
16134	Zinc Plated	3/8	7	3/8	5-7/8
16135	Zinc Plated	1/2	2-3/4	1/2	1-3/8
16136	Zinc Plated	1/2	3-3/4	1/2	2-3/8
16137	Zinc Plated	1/2	4-1/2	1/2	3-1/8
16138	Zinc Plated	1/2	5-1/2	1/2	4-1/8
16139	Zinc Plated	1/2	7	1/2	5-5/8
16140	Zinc Plated	5/8	3-1/2	5/8	2
16141	Zinc Plated	5/8	5	5/8	3-1/2
16142	Zinc Plated	5/8	6	5/8	4-1/2
16143	Zinc Plated	5/8	7	5/8	5-1/2
16144	Zinc Plated	5/8	8-1/2	5/8	7
16146	Zinc Plated	3/4	4-1/4	3/4	2-3/8
16147	Zinc Plated	3/4	5-1/2	3/4	3-5/8
16148	Zinc Plated	3/4	7	3/4	5-1/8
16149	Zinc Plated	3/4	8-1/2	3/4	6-5/8
16150	Zinc Plated	3/4	10	3/4	8-1/8
16160	Zinc Plated	1	6	1	2-3/8

## Slotted Flat Head Sleeve Anchors



Item ID	Diameter	Length	Bolt Diameter	Min. Imbedment
16217	3/8	4	5/16	1-1/4
16219	3/8	5	5/16	2
16220	3/8	6	5/16	2

# ANCHORS

## Drop-In Anchors



Zinc Plated  
Carbon Steel

This anchor is a heavy duty anchor that is set by means of an internal expanding plug and setting tool. Once the hole is drilled, the anchor is placed in the hole and set by the blow from a hammer - directly on the setting tool.

Can be used in cinder block or concrete. Ideal for hanging pipe, duct work, machinery, etc.

Item ID	Rod Size	Hole Size	Thread Depth	Min Drill Depth	Pull-Out Value	Shear Value
16032	1/4	3/8	7/16	1	2160	1700
16034	3/8	1/2	5/8	1-9/16	5815	3910
16036	1/2	5/8	13/16	2	8510	6520
16038	5/8	7/8	1-3/16	2-1/2	15260	9700
16040	3/4	1	1-3/8	3-3/16	16700	14200

## Steel Drop in Anchor Tool



Item ID	Size
16010	1/4
16011	3/8
16012	1/2
16013	5/8

## Double Expansion Shields



The Double Expansion Shield is designed to be used in all types of masonry, as well as other soft materials.

Simply drill a hole in the material and drop threaded end into hole.

Fastens with machine screw or bolt.

Item ID	Screw Size	Drill Size	Min Drill Depth
16042	1/4	1/2	1-1/4
16043	5/16	5/8	1-1/2
16044	3/8	3/4	1-3/4
16046	1/2	7/8	2-1/4

# ANCHORS

## Wedge-Bolts



Wedge-Bolts are a universal anchor for high strength applications that work in virtually all base materials. This includes concrete, block, brick and stone. This anchor requires no assembly and is a “screw-in” design.

- Can be removed and re-installed in the same hole or a new hole
- To determine the proper length needed, determine the embedment depth required to obtain the desired load capacity. After that, add the thickness of the fixture to the embedment depth.
- **Use with Wedge-Bolt Drill Bits**
- Sold by the each

Item ID	Diameter	Length	Minimum Embedment	Box Qty	Drill Bit #
16352	1/4	2-1/4	1"	100	10841
16354	3/8	1-3/4	1-1/2"	50	10843
16355	3/8	2-1/2	1-1/2"	50	10843
16356	3/8	3	1-1/2"	50	10844
16358	3/8	5	1-1/2"	50	10845
16361	1/2	2-1/2	2"	50	10847
16362	1/2	3	2"	50	10848
16364	1/2	5	2"	25	10849
16368	5/8	3	2-1/2"	25	10851
16369	5/8	4	2-1/2"	25	10851

## Wedge-Bolt Drill Bits



- SDS-Plus shank

Item ID	Anchor Size	Usable Length	Overall Length
10841	1/4	4	6
10843	3/8	4	6
10844	3/8	6	8
10845	3/8	10	12
10847	1/2	4	6
10848	1/2	8	10
10849	1/2	10	12
10851	5/8	6	8